

ST. JAMES PARK – PLANTING PROPOSAL

The following proposal outlines the various areas we have identified for new or replacement planting:

Lavender from Meadow Area to be moved and replanted on roundabout

Beginning of Williams Grove/Savery Drive: Vine Weevil infested Euonymus to be replaced with double rows of Lavender (4x areas of 15m<sup>2</sup> approx.)



Chadwick Pl. Hedging: Remove Taxus diseased by Vine Weevil (straight runs either side of Chadwick Pl.) and reseed with grass. Patch plant reusing any healthy plants removed

Williams Gr. Hedging: Remove all Taxus hedging plants damaged by Vine Weevil and replace with Carpinus hedging

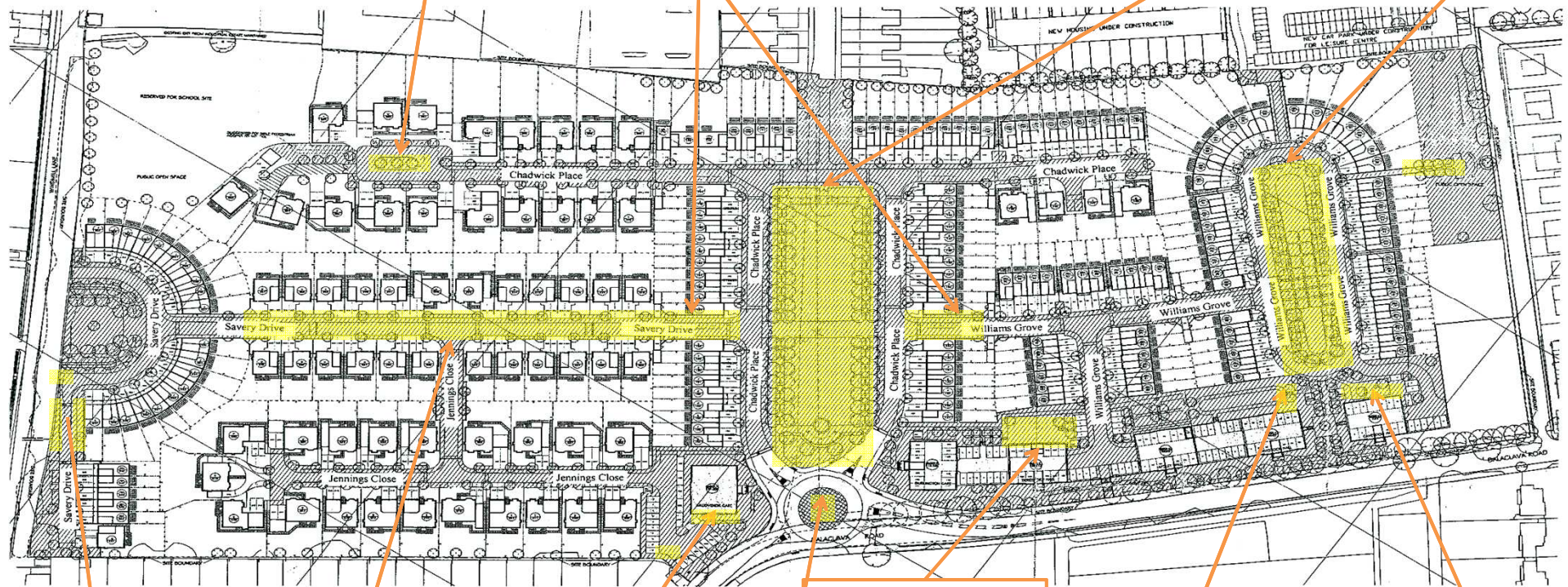

Wedge shaped bed to be created at base of hedge (opposite No. 47) and planted with Pachysandra (30m<sup>2</sup>)

Bed opposite – in-fill planting (12No plants)

Fill gaps in beds in front of individual houses: No.1,2,4,7,9,10,16,17,18,19, 20 and 22 (total 55No)



Back of building nr roundabout – mature Ceonothus needed to replace dead specimens (1No?)  
Front of building – in-fill planting?

Roundabout and semi-circle redesign (see separate proposal)

Formal Oval lawn No.2: Gaps in planting beds to be in-filled

Remove Euonymus beneath multi-stemmed Birch and replace with groundcover plants

Timber Pavilion formal garden: ground cover needed to fill gaps in beds (13m<sup>2</sup> approx.)

Timber Pergola at end of formal Oval lawn No.1: Climbers (8No plants)



Parterre: Convolvulus in-fill



ST. JAMES PARK – LANDSCAPE MAINTENANCE REPORT

- Landform have been maintaining the landscape at St James Park since 1<sup>st</sup> March 2011
- We have taken great pride in re-establishing a comprehensive level of horticultural care throughout the site and have been working hard to remedy areas that had been neglected
- We have taken ownership of the landscape and work hand-in-hand with Wallakers to offer proactive solutions and plans to the make the landscape better
- We have formulated a plan of action for the future which includes extensive replacement planting

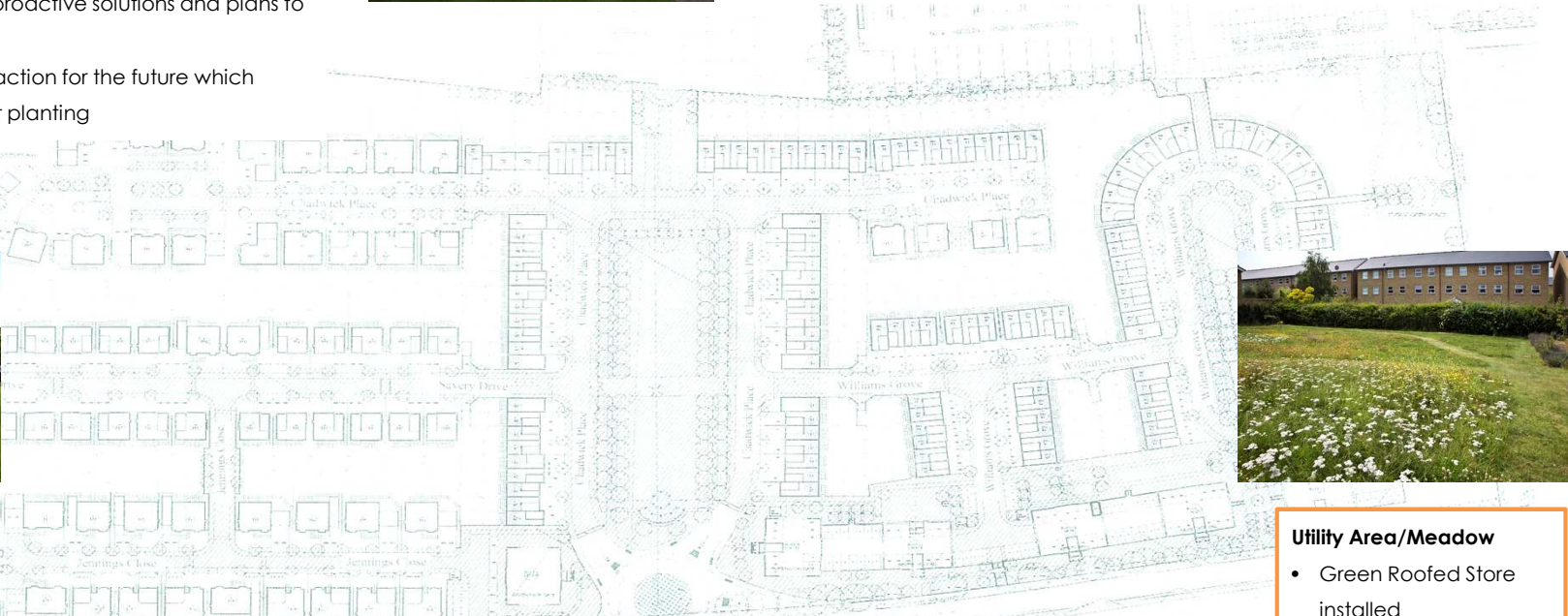

**Pests & diseases**

- Plants killed or damaged beyond repair by Vine Weevil are in the process of being removed and disposed off site
- Any plants which have the chance of recovery have been treated with Biological control (Nematodes)

**Grass areas**

- Edges redefined
- Fed with fertiliser
- Scarification

**Hedging**

- Pruned to re-establish shape & clean lines
- Fed with fertiliser
- Weeded

**Planting beds**

- Weeded & cleared of debris
- Fed with bonemeal
- Mulched with compost made on site
- Edges redefined
- Gaps to be filled with new planting

**Shrubs**

- Roses, Hebes & other shrubs pruned to retain shape and promote healthy growth and flowering potential

**Tree pits**

- Weeded
- Edges redefined

**Utility Area/Meadow**

- Green Roofed Store installed
- Compost facilities installed – these have already turned out highly nutritious compost back onto the beds
- Mown paths introduced to meadow area
- Wild flower cultivation encouraged in meadow



ST. JAMES PARK – ROUNDABOUT/VERGE PLANTING  
MOOD BOARD



*Deschampsia cespitosa*  
(Spread: 1200 x Height: 1500)



*Gleditsia triacantus* Sunburst



*Agapanthus* Back in Black  
(Spread: 300 x Height: 650)



*Cirsium rivulare* 'Atropurpureum'  
(Spread: 600 x Height: 1200)

*Lavandula angustifolia* 'Hidcote'  
(Spread: 750 x Height: 600)



*Allium sphaerocephalon*  
(Height: 600)



*Geranium macrorrhizum* 'bevan's variety'  
(Spread: 600 x Height: 500)



*Salvia officinalis* 'Purpurascens'  
(Spread: 1000 x Height: 800)